



Quad Pod K50 / K65

Rapid Deployment Mobile Lighting System

Operator's Manual



This manual covers all configurations with part numbers beginning:

K50/MK5-L2X3/ | K50/MK5-L3X3/ | K50/MK5-L3X4/ | K65/MK5-L2X3/ | K65/MK5-L3X3/ | K65/MK5-L3X4/

The information contained in this manual is based on products manufactured up to the time of publication. Ritelite (Systems) Ltd reserves the right to change any of this information without notice.

No part of this manual may be reproduced in any form or by any means, electronic or mechanical without express written permission from Ritelite (Systems) Ltd.

Any type of reproduction or distribution not authorized by Ritelite (Systems) Ltd represents an infringement of valid copyrights, and violators will be prosecuted. We expressly reserve the right to make technical modifications, even without due notice, which aim at improving our products or their safety standards.

IMPORTANT INFORMATION ABOUT YOUR QUAD POD

Use this page to record important information about your Quad Pod.

UNIT PRODUCT REFERENCE	
UNIT SERIAL NUMBER	

This information can be found on your Quad Pod's data plate which is found on the back of the mast.

NOTE: Below is an example of the K50/K65 data plate.

RITELITE (SYSTEMS) LTD					
PRODUCT	K65 QUAD POD PORTABLE LIGHTING TOWER				
PRODUCT CODE	K65/MK5-L3X4/240/T60309				
SUPPLY VOLTAGE	240V AC 50/60HZ				
OPERATING POWER REQUIREMENT	1550W				
IP RATING	IP44	MANUFACTURE DATE	Jul 2023		
HEIGHT (MAX)	6.2m	HEIGHT (MIN)	1.95m	WEIGHT	237Kg
SERIAL NUMBER	0000000	Made in the UK			
Ritelite (Systems) Ltd, Meadow Park, Bourne Road, Essendine, Stamford, Lincolnshire, PE9 4LT, England Tel. +44 (0) 1780 758585 Fax. +44 (0) 1780 765700 E-mail. sales@ritelite.co.uk Web. www.ritelite.co.uk					

You will be required to supply the products serial number when contacting Ritelite (Systems) Ltd or one of Ritelite's approved dealers about parts and service.

IMPORTANT SAFETY INSTRUCTIONS

Some versions of this product are fitted with a polarized plug (one pin is wider than the other) as a feature to reduce the risk of electric shock. This plug type will fit in a polarized outlet only in the correct orientation. If the plug does not fit fully in the outlet, reverse the plug. If it still does not fit contact a qualified electrician. Never use with an extension cord unless plug can be fully inserted. Do not alter the plug.

CONTENTS

SECTION TITLE	PAGE NUMBER
Section 1: Introduction & Applications for use	4
Section 2 : Safety Rules	5
Section 3: Technical Specifications	10
Section 4: Safety and Operating Labels	11
Section 5: Setting up the Quad Pod	14
Section 6: Operating Instructions	15
6a) Pre-operation inspection	15
6b) Unit Stability Deployment Process	16
6c) Function Tests	19
6d) Raising and Lowering Mast Process	20
6e) Packing away and Transport	29
Section 7: Maintenance	32

Section 1: INTRODUCTION & APPLICATIONS FOR USE

The Quad Pod is designed as a simple to use but powerful portable LED lighting system. It should only be used as a device to provide light as designed and for no other purpose.

All users must read, understand and obey these safety rules and operating instructions before operating the Quad Pod lighting system. Only trained operators or competent personnel should operate the Quad Pod.

This manual should stay with the Quad Pod at all times.

Users should be made aware of the online version of the manual, setup video and other resources which can be viewed at the following link.

<https://ritelite.co.uk/product-resources/qp-mk5/>

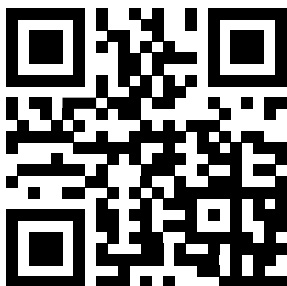

Quad Pod MK5
Setup instructions & resources

APPLICATIONS FOR USE

The Quad Pod mobile lighting system is designed for use in the following applications only. It should not be used for any other purpose. If in any doubt about applications for use please contact either Ritelite (Systems) Ltd or Ritelite (Systems) Ltd's distributor for more information.

- Sports lighting indoor and outside
- Indoor area lighting
- Area lighting for construction site /scene lighting
- Area lighting for events applications
- Maintenance work
- Rescue operations
- Media and film



WARNING



Failure to follow the instructions and safety rules in this manual may result in death or serious injury.

Section 2: SAFETY RULES

It is important that every user understands and observes the safety rules before setting up or using the Quad Pod Lighting System.

The Manufacturer, Ritelite (Systems) Ltd cannot anticipate every possible circumstance that might involve a hazard. The warnings in this manual and on labels affixed to the Quad Pod will therefore not cover every eventuality. If using a procedure or operating method not specifically recommended by the manufacturer then the user must verify that it is safe for others and that it does not make the equipment unsafe.

Throughout this manual and on labels on the Quad Pod, DANGER, WARNING and CAUTION blocks are used to alert personnel to special instructions about a particular operation that may be hazardous if performed incorrectly or carelessly. Observe them carefully. Their definitions are as follows:

 DANGER	 WARNING	 CAUTION
Indicates a hazardous situation which, if not avoided, will result in death or serious injury.	Indicates a hazardous situation which, if not avoided, could result in death or serious injury.	Indicates a hazardous situation which, if not avoided, could result in minor or moderate injury.

These safety alerts cannot eliminate the hazards that they indicate. Common sense and strict compliance with the instructions within this manual are essential to preventing accidents.

WARNING

When using outdoor use portable luminaires, basic safety precautions should always be followed to reduce the risk of fire, electric shock and personal injury including the following:

- a) **Use only three-wire outdoor extension cords that have three-prong grounding plugs and grounding receptacles that accept the appliance's plug.**
- b) **Residual Current Device (RCD) protection is to be provided on the circuits (s) or outlet (s) to be used for the wet location portable luminaire. Receptacles are available having built-in RCD protection and are able to be used for this measure of safety.**
- c) **Use only with an extension cord for outdoor use.**

GENERAL SAFETY RULES & POTENTIAL HAZARDS WHEN SETTING UP AND USING THE QUAD POD LIGHTING SYSTEM

FALL HAZARDS

- Do not stand on any part of the mast or light head brackets
- Do not cling to or pull on the mast

TIP OVER HAZARDS

- Do not raise the mast until the Quad Pod is positioned level on a firm, flat, horizontal surface with all four support legs correctly deployed and locked.
- Do not place the Quad Pod on a smooth low friction surface even if firm and level. e.g. snow/ice. The unit could be prone to sliding sideways in these circumstances.
- Do not set up the Quad Pod in windy conditions where wind speed and gusts could exceed the wind rating of the product.
- Check area where the product has been set up on a regular basis to ensure stability has not been compromised through changing conditions, e.g. through wind or water logged ground.
- Ensure the leg retainer pin is fully located in hole A and tensioned by adjusting tie bar before attempting to raise the mast.
- Do not raise the mast until all 4 leg retainer pins are correctly inserted through the leg holes.
- Do not remove the leg retainer pins when the mast is raised.

- Prior to setting up check the area for any possible hazardous conditions.
- Do not use blocks to level the Quad Pod.
- Do not move the Quad Pod with a raised load.
- Do not place ladders or scaffolding against any part of the Quad Pod.
- Do not use the Quad Pod on a moving or mobile surface or vehicle.
- Avoid debris and uneven surfaces when rolling a Quad Pod with the legs folded up.
- Do not use the Quad Pod for any purpose other than that for which it is designed.
- The Quad Pod is NOT a lifting device for anything other than the fitted Light heads.

ELECTROCUTION HAZARDS

- Maintain safe distances away from electrical power lines in accordance with applicable governmental regulations.
- Keep away from the Quad Pod if it contacts energized power lines. No-one must touch or operate the Quad Pod until power lines are shut off.
- When setting a Quad Pod up in an area which does have electrical power lines in the vicinity allow enough distance for mast movement and electrical line sway or sag and be aware of strong or gusty winds.
- Ensure product is not being set up in a potentially explosive environment – the Quad Pod is not an ATEX approved product.
- Ensure the product will be powered by an RCD protected supply to prevent risk to operators or damage to the Quad Pod.
- The Quad Pod is not designed to be submersed under water.

BODILY INJURY HAZARDS

- It is recommended that the user wears gloves whilst operating or setting up the Quad Pod.
- In slippery or uneven terrain it is recommended that two people manoeuvre the product at all times.
- Reasonable effort is required to set the product up. More than one person may therefore be required.
- Do not manoeuvre the Quad Pod product for long distances in extreme temperatures.
- Do not switch on light heads until mast is raised.
- Do not stare directly into the lights to prevent damage to eyes.
- Set the Quad Pod up so light spill cannot form a nuisance or danger to others, especially those using machinery.
- Where possible the Quad Pod should be set up away from personnel or moving vehicles.
- Do not grasp the mast cable.
- Do not pull product long distances in extreme temperatures. It is recommended that two people manoeuvre the product in extreme temperatures.

CRUSHING HAZARDS

- Ensure the Quad Pod is set up on a firm and horizontal flat surface.
- Do not raise the mast until the Quad Pod is positioned level on a firm horizontal flat surface with all four support legs correctly deployed and locked.
- Do not stand under or allow personnel under the Quad Pod when the mast is raised or lowered.
- Keep hands and fingers away from folding legs and other potential pinch points.
- Maintain a firm grasp on the leg when the retaining pin is removed. The leg will drop downwards causing possible risk to operator.
- Never move the Quad Pod with the mast partly or fully raised.

COLLISION HAZARDS

- Ensure the area around the product and above the product is clear of any possible obstructions before starting to set the Quad Pod up.
- Use common sense and planning when transporting the Quad Pod on any incline or slope.
- On slippery or uneven terrain it is recommended that two people manoeuvre the product at all times.
- Do not load for transport unless the Quad Pod and vehicle are on a level horizontal surface. Use proper lifting techniques to load the machine to prevent collision into other items on the transport vehicle.

DAMAGED MACHINE HAZARDS

- Do not use a damaged Quad Pod or a Quad Pod that is not working properly.
- Do not use a Quad Pod with a worn, frayed, kinked or damaged cable.
- Conduct a thorough pre-operation inspection prior to each use.
- Be sure that all labels are in place and legible.
- Do not use if there are any visible damaged parts. Contact your dealer to arrange for spares or repair options.
- Do not use any type of lubrication on the column surfaces.

IMPROPER USE HAZARD

- Never leave a Quad Pod unattended with the mast raised unless a full risk assessment for the application they are being used for has been undertaken by a competent person. Unauthorized personnel may attempt to operate the Quad Pod without proper instruction potentially causing injury to themselves or others.
- Do not place the Quad Pod on a smooth low friction surface even if firm and level. e.g. snow/ice. The unit could be prone to sliding sideways in these circumstances.
- The Quad Pod must only be operated in a vertical position.

- The device is to be used only for its prescribed purpose. Any use other than that mentioned is considered to be a case of misuse.
- The user/operator, and not the manufacturer shall be liable for any damage or injury resulting from such cases of misuse.
- The Quad Pod is designed for hand operation. Any kind of motorising is prohibited. It is also imperative to observe the local accident prevention regulations.
- The same applies for the general rules of occupational health and safety.
- The manufacturer is not liable for indirect consequential damage and financial loss.
- The manufacturer shall not be liable for any changes made to the device nor for any damage resulting from such changes.
- The Quad Pod is not designed to be towed on a public highway.

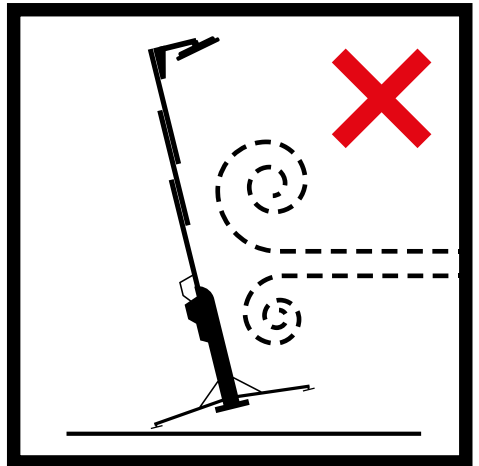
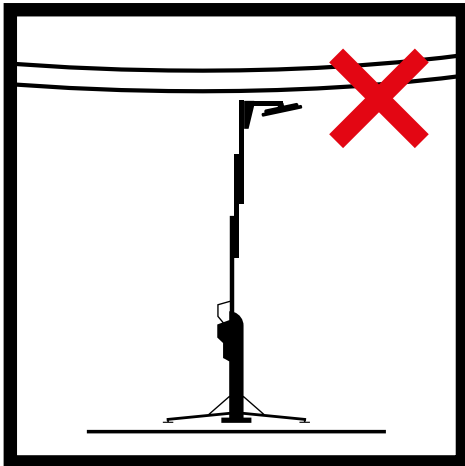
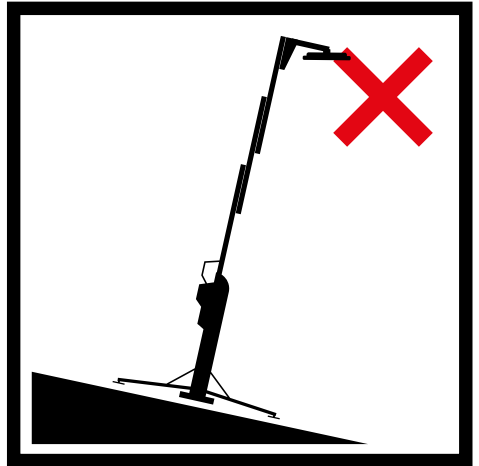
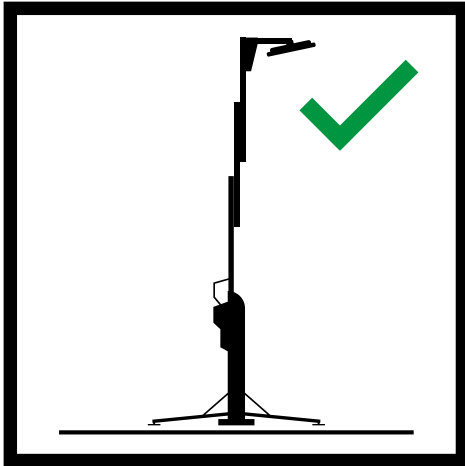

Section 3: TECHNICAL SPECIFICATIONS

PRODUCT CODE	WATTAGE	LUMENS	NUMBER OF LIGHT HEADS	WEIGHT	110V AMPS	240V AMPS
K50/MK5-L2X3/	730W	97,000	2	215Kg	7A	3.25A
K50/MK5-L3X3/	1100W	146,000	3	220Kg	10.5A	4.9A
K50/MK5-L3X4/	1460W	195,000	3	225Kg	14A	6.5A
K65/MK5-L2X3/	730W	97,000	2	227Kg	7A	3.25A
K65/MK5-L3X3/	1100W	146,000	3	232Kg	10.5A	4.9A
K65/MK5-L3X4/	1460W	195,000	3	237Kg	14A	6.5A

K50 DIMENSIONS

Closed dimensions: 1.09 x 0.83 x 1.95m. Open dimensions: 2.37 x 3.1 x 5m
(Max height with mast up without heads deployed - 5.42m)

K65 DIMENSIONS

Closed dimensions: 1.09 x 0.83 x 1.95m. Open dimensions: 2.37 x 3.1 x 6.5m
(Max height with mast up without heads deployed - 6.76m)

GENERAL SPECIFICATIONS

- IP65 - Subject to plug type fitted
- Colour temperature 6500K
- Mains input via 110/240V plug/coupler link through as per customer requirements
- Operating temperature range -20°C to +30°C

Section 4: SAFETY AND OPERATING LABELS

LABEL POSITIONS

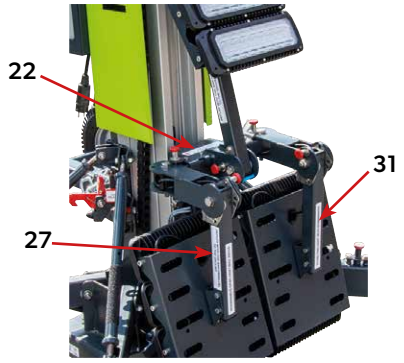



RAISING MAST

1. Push mast to vertical position onto its base on **firm, horizontal level ground**.
2. Lower stability legs by applying pressure to the log towards mast and simultaneously releasing the rod log release catches.
3. When legs are lowered, ensure foot pad is in contact with the ground and that pin 'B' is fully engaged into one of the holes A on top (adjust tie bars 'C' if necessary to align pin 'B' with a hole 'A').
4. Using the bubble level as a guide adjust all four tie bars 'C' to ensure base is level. Ensure all four legs are applying pressure to the ground.
5. Turn wind handle 'D' clockwise to raise light heads to chest height. Adjust heads to positions required, then raise mast to desired height.
6. The mast is fully extended when the two 'MAX HEIGHT' arrows align. Do not exceed this height.

LOWERING MAST

1. Re-tension the lifting wire by winding winch handle slightly clockwise to take the most load.
 2. Press and hold the safety latch release button 'E' and lower the mast using winch handle 'D' in an anti-clockwise direction. If the safety latch release button 'E' will not press, then wind winch handle 'D' clockwise a fraction until button 'E' will function. The safety latch release button 'E' needs to be held in during the descent to prevent the safety latches locking into the mast.
- If the winch handle stops rotating during lowering, this will be due to the 'wire tensioning device' preventing the winch rope from 'mis-layering'. To clear handle stoppage: rotate the handle clockwise 360 degrees to re-tension the rope, now continue to lower. (from 2 above). Ensure button 'E' is fully pressed in.*
3. When the light heads reach chest height fold them back into their stowed positions, then continue lowering the mast remembering to hold in button 'E'.
 4. Once mast is fully lowered rotate tie bars 'C' clockwise until slack. Ensure unit is stable. Pull out pins 'B' and push log on to leg catch to secure leg for transit.
 5. Ensure the transport wheel set is secured before pulling unit onto wheels for transporting.



19 20
STRAP DOWN POINT STRAP DOWN POINT

21
Suitable for use in dry, damp and wet conditions

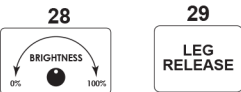
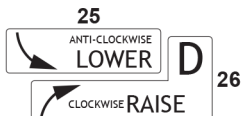

34
Do not tamper with wire tensioning device under this cover. Doing so will damage unit.



22
Pull out red pins to adjust light heads

27
DEPLOY WITH THIS BAR PARALLEL TO THE GROUND

30
STORE THIS LIGHT HEAD UPWARDS

31
STORE THIS LIGHT HEAD DOWNWARDS

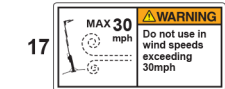
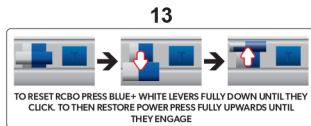
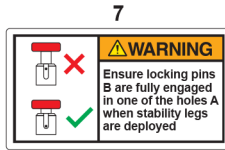
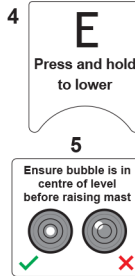
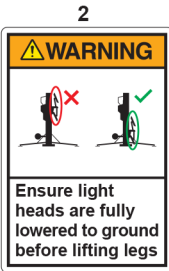

18 **MAX HEIGHT**



39

RITELITE (SYSTEMS) LTD	
PRODUCT	K65 QUAD POD PORTABLE LIGHTING TOWER
PRODUCT CODE	K65/MK5-L3X4/240
SUPPLY VOLTAGE	240V AC 50/60HZ
OPERATING POWER REQUIREMENT	1550W
IP RATING	IP44
MANUFACTURE DATE	Jan 2023
HEIGHT (MAX)	4.2m
HEIGHT (MIN)	1.95m
WEIGHT	237kg
SERIAL NUMBER	0000000
Made in the UK	CE

Units Shipped UK, Mainland UK, Inland EU, Excludes: Scotland, Ulster/NI, EU A1, Ireland
Tel: +44 (0) 1790 758500 Fax: +44 (0) 1790 767500 Email: sales@ritelite.co.uk Web: www.ritelite.co.uk

RITELITE 36 **K50** **K65** 38

REF.	DESCRIPTION	QUANTITY
1	Instructions for raising and lowering the mast	1
2	Light head position when stationary warning	1
3	Light head position when transporting warning	1
4	Mast safety lock button E	1
5	Bubble level	1
6	WARNING – trained personnel / gloves / locking pin check	1
7	Locking pin check to secure legs	4
8	Leg locking pin B	4
9	Tie bar C to secure legs	1
10	CAUTION – risk of electric shock	2
11	Locking pin hole A location	2
12	Locking pin hole A location	2
13	RCBO reset instructions	1
14	Strap down point - base	2
15	Strap down point - base	2
16	Leg release catches	1
17	WARNING – do not use in winds over 30MPH	1
18	Max Height indication	1
19	Strap down point - top	1
20	Strap down point - top	1
21	Suitable for use in dry, damp and wet conditions	1
22	Pull out red pins to adjust light heads	1
23	Indicate when mast is at Max Height. WARNING - do not continue to wind winch handle	1
24	Indicate when mast is at Max Height. WARNING - do not continue to wind winch handle	1
25	Winch operating direction - lower	1
26	Winch operating direction - raise	1
27	Deploy with this bar parallel to the ground	3
28	Brightness adjustment	1
29	Leg release lever	4
30	Store this light head upwards	1
31	Store this light head downwards	2
32	Earthing point	1
33	QR code label - link to resources on web page	1
34	Do not tamper	1
35	Lifting point (not shown - only on specific models as option)	1
36	Ritelite *	2
37	K50 product name *	2
38	K65 product name *	2
39	Product data plate including serial number and weight information	1

* These labels are subject to change depending on individual customer configurations.

Section 5: SETTING UP THE QUAD POD

Inspect the proposed area for use.

An inspection of the proposed area in which to set up the Quad Pod is necessary to ensure it is suitable for safe operation. This inspection should be performed by the operator prior to moving the Quad Pod into position. The area should be firm, horizontal, level and free from obstructions.

WARNING

Operators should be aware of the following possible hazardous situations. The operator should also remember these hazards, watch and avoid them while moving, setting up and operating the Quad Pod.

- **Wet and unstable ground**
- **Uneven terrain, drop-offs or holes**
- **Bumps and floor obstructions**
- **Debris either on proposed site or on route to site**
- **Overhead obstructions and high voltage conductors**
- **Inadequate surface support to withstand the Quad Pod weight**
- **Wind and weather conditions – ice, snow, gusty or strong winds being particularly hazardous to the safe use of the Quad Pod**
- **All other possible unsafe conditions**

Arrange the angle of the light heads as far as possible to ensure that the light heads are not likely to dazzle people in the near vicinity.

Set the Quad Pod up in such a way that it cannot obstruct walkways or areas that form emergency exit routes.

WARNING

The Quad Pod can be used indoors or outdoors. Note Recommended Maximum Wind Speed.

Wherever there is any doubt over the wind speed/conditions the Quad Pod should be lowered for safety.

Wind speed at 100% height - 30 mph

If using the Quad Pod for extended periods, a daily check of the unit is required to prevent against misuse or tampering whilst unattended, and to ensure that the surface is still firm, level and stability is not compromised in any way e.g. waterlogged ground.

Ensure area around the Quad Pod is clear of any persons before raising mast. Only one operator should be behind the unit operating the winch.

Section 6: OPERATING INSTRUCTIONS

Do not use the Quad Pod for any purpose other than that for which it is designed – as a mobile floodlighting system.

If more than one operator is expected to set up or use a Quad Pod Lighting System at different times, each operator is required to follow all safety rules and instructions in the operators manual. That means every new operator should perform a pre-operation inspection and function tests before using the Quad Pod.

6a) PRE-OPERATION INSPECTION

Always perform a pre-operation inspection.

The Pre-operation inspection is a visual inspection performed by the operator prior to each use of the Quad Pod. This inspection is designed to discover if anything is obviously wrong with a unit before the operator tests it prior to use.

A damaged or modified Quad Pod must never be used. If any damage is discovered the Quad Pod must be removed from service until it has been repaired.

Maintenance and repairs can be executed only by authorised personnel. If any person maintaining or repairing the device is in any doubt they should contact their dealer or Ritelite (Systems) Ltd.

PRE-OPERATION INSPECTION

Check the following parts or areas for any signs of damage or missing parts.

- Leg locking pins
- Cables (for kinks, frays, abrasions)
- Plugs
- Lifting eye (if fitted)
- Legs / tie bars
- Mast columns
- Nuts, bolts and other fasteners
- Check to make sure that there are not dents, weld cracks in the product or signs of rust.
- Check the tyres are inflated adequately and do not exceed the maximum pressure stated on the tyres.
- Check the axle pivot point and locking pin to make sure it is fully engaged and locked.
- Make sure the transit locks are fully engaged.
- Make sure that all structural and other critical components are present and all associated fasteners and pins are in place and properly tightened.

Make sure all labels and warnings are present and readable on the product as detailed in section 4 of this manual.

6b) UNIT STABILITY DEPLOYMENT PROCESS

These instructions are also available online via the QR code on the winch cover of the Quad Pod.



1. Push mast to a vertical position onto its base on firm, horizontal ground, away from overhead obstacles such as trees or power lines. On slippery or uneven terrain it is recommended that two people manoeuvre the product at all times. Site the unit so that all four of the stabilizing legs can be located on firm ground when deployed.



2. Lift the cover to the fuse box and check that the power switch is turned off, it should be in the down position. Check the dimmer is rotated fully anti-clockwise to the 0% position.

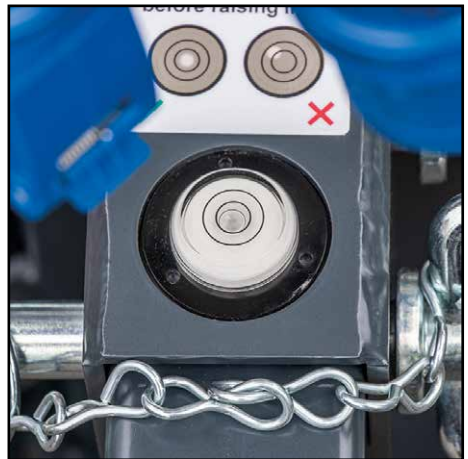

3. Make sure that the base is level using the bubble level (the bubble should be within the smallest circle). The base is designed to take the weight of the unit during operation so it is critical to ensure the ground will support the full weight of the unit without giving way during the unit deployment.



4. To lower the support legs apply pressure to the leg towards the mast (this will enable the release catch to be operated) and push the release catch.



5. Pull out and hold locking pin B and lower leg to the ground. Release the locking pin.



6. Rotate the tie bar C and ensure locking pin B fully engages in the leg into one of the holes A. Continue to rotate the tie bar until the load pad has made firm contact with the ground. Lower and secure the other three legs in the same way, then check again that all four load pads are secure.



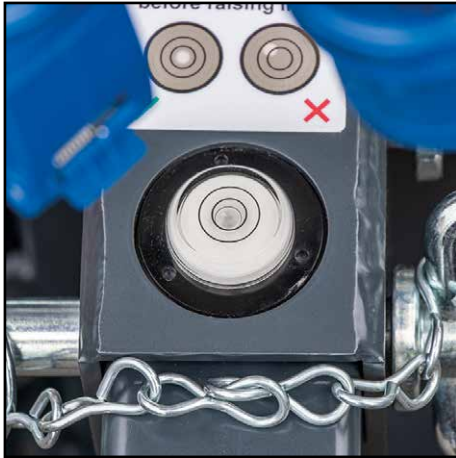

7. Once all legs are firm and pins locked in place check the bubble level again to ensure it is still reading true, the bubble should be within the smallest circle. If not minor adjustments can be made by adjusting tie bars C. Re-check the legs and mast are all firm if any adjustments are made.



8. After all 4 legs are lowered the transport locks will be activated and automatically allow release of the mast sections.

 **WARNING**

It is important that all legs are lowered with locating pins fully secured in hole A and secured to ensure that the mast sections are not released until the legs are set up correctly.

6c) FUNCTION TESTS

Before each and every use it is recommended that the following function tests are carried out to make sure that there are no operational issues with the Quad Pod before set up continues.

Any Quad Pod that is not working properly must not be used and must be removed from service until a full inspection and any necessary repairs have been carried out.

Maintenance and repairs can be executed only by authorised personnel.

If any person maintaining or repairing the device is in any doubt they should contact their dealer or Ritelite (Systems) Ltd.

After repairs are completed, the operator must perform a pre-operation inspection and function tests again before the Quad Pod is used.

- Select a test area that is firm, horizontal, level and free from obstructions.

Follow the setting up procedure to stage 8 when the Quad Pod is properly stabilised and the legs are all down and locked securely and the light heads are cleared from the transport locks.

Test of winch operation

1. Raise the light heads by firmly grasping the winch handle and turning it in a clockwise direction from the operator.

Result – the winch should operate smoothly free from hesitation or any friction

2. Lower the light heads by pressing and holding button E, and rotate winch handle D anti-clockwise to lower the mast.

Result – the winch should operate smoothly free from hesitation or any friction.

6d) RAISING AND LOWERING MAST PROCESS

RAISING THE MAST

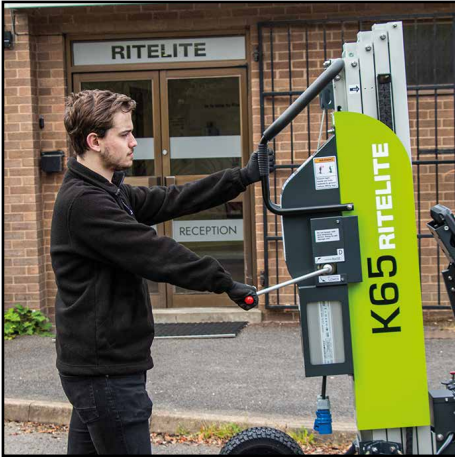

1. Wind winch handle D clockwise to raise the light heads enough to clear the transport locks. Allow room for the light heads to be setup and adjusted as required.



2. Continue to wind up until the centre bracket of the light heads is around chest height, roughly in line with the K50 / K65 logo.



3. Adjust the light heads to the required angles, starting with the side brackets. Horizontal adjustment is made by lifting up the locking plungers on the top of the main light head bracket. While held up twist either the left hand or right hand light head to the desired position.



4. Vertical adjustment is made by pulling out the locking plungers on the side the individual light head brackets. Whilst supporting the head with one hand use the other hand to release the plunger. Adjust to desired angle and release plunger until it locates in hole.



5. For standard 180° setup the outside light heads should be setup as shown above by locating the locking pins in the relevant holes. Due to the beam control lens the light heads need to be set to approx 15° from horizontal.



6. Pull out the vertical locking pin for the centre light head and lower to the same angle as the side light heads.



7. For standard 180° setup the light heads should be setup as shown above.

The light heads can also be setup in a couple of other positions for other applications, please see page 24 for a summary of all three.

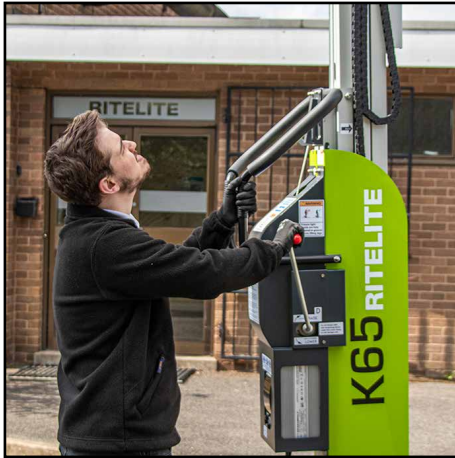

8. Continue to raise the mast to the desired height by rotating the winch handle clockwise. As you raise the mast you will hear a clicking sound as the safety lock connects to each lock point.



9. When the mast is at the desired height stop winding. Now wind the handle in the opposite direction slightly until the mast safety lock E engages. The load should now be supported by the safety locks as well as the winch wire.



WARNING

As you raise the mast always be conscious of other personnel and the surrounding area above and around the Quad Pod. No persons other than the Quad Pod operator should be in the vicinity of the Quad Pod when the system is being set up.



CAUTION

The mast is fully extended when the two 'Max Height' arrows align. Do not try to exceed this height.



10. It is now safe to turn the Quad Pod on at the switch. Lift cover and switch to on position.



11. Rotate the dimmer clockwise to the desired light level.

⚠ CAUTION

The light must NOT be set up in a way that it may form a hazard or nuisance to other persons.

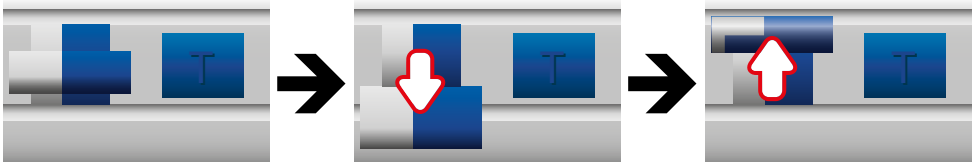

NOTE If the RCBO has tripped, the power switch will not go fully down and will not switch to the on position until it is reset. To reset the RCBO press the blue & white levers fully down until they click. To then restore power press fully upwards until they engage.

180° LIGHT HEAD SETUP



360° LIGHT HEAD SETUP

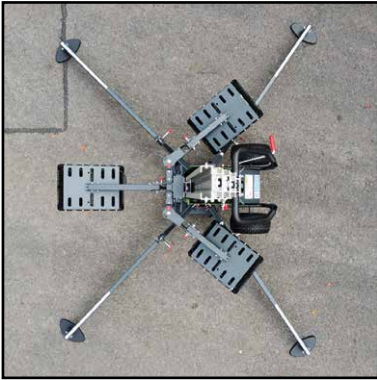

WALL WASH LIGHT HEAD SETUP



LOWERING THE MAST

CAUTION

Make sure the Quad Pod is stable and no adjustments have been made, or ground firmness has changed whilst the Quad Pod has been left unattended.



1. Switch the main power to the light heads off by lifting the cover and setting the switch position to off. Disconnect the power source.



2. Re-tension the lifting wire by winding the winch handle D clockwise slightly to take the mast load. Press and hold safety button E and rotate winch handle D anti-clockwise to lower the mast.

CAUTION

If at any point you are unable to press in button E you may need to rotate the winch handle clockwise slightly to lift the load off the safety latches to allow button E to be pressed in, once the button is pressed in then you may continue winding the handle anti clockwise to lower the mast section. The Quad Pod employs a unique cable control system that will only allow a slight anti clockwise movement of the winch handle if it detects a slack or broken cable. This prevents excessive cable being spooled out from the winch and potential safety issues occurring.



3. Continue to wind until the light heads are at chest height then stop. Adjust the light heads to their original positions so the outer light heads are rotated in as far as they will go. The outer heads then should be fully lowered and the central head fully raised.



4. Continue to lower the final mast section until the light heads are nearly touching the ground and all mast sections are flush at the top.

WARNING

As you lower the mast always be conscious of other personnel and the surrounding area above and around the Quad Pod. No persons other than the Quad Pod operator should be in the vicinity of the Quad Pod when the system is being taken down.



5. Make sure the light heads are pulled towards each other enough to allow the legs to be raised without obstruction.



6. Make sure the ground has remained firm and the unit will stand stable after the legs are packed away, if in any doubt enlist the help of others to support or steady the Quad Pod as required. Raise the legs in any order to lock the mast into position. Rotate tie bars C clockwise until locking pins B can be pulled free.



7. Pull and hold out pins B as you lift the legs and return to their retaining lever on the mast.



8. Push the leg towards the mast, against the AV mount until the Red retaining lever holds the leg.



9. Once all 4 legs are raised and locked this will hold the mast secure and preventing it from being raised. **The user must ensure that the mast is fully retracted and that the mast lock is correctly engaged as per the picture.**



10. Make sure the transport wheel set is secured with the transport locking pin fully engaged, and the spring locking pin secured through the transport locking pin to ensure it will not slide out.



11. Grasp the handles on the mast and take the Quad Pod's weight as you lower it gently onto the wheels for transport. On slippery or uneven terrain it is recommended that two people manoeuvre the product at all times.

6e) PACKING AWAY & TRANSPORT

CAUTION

In slippery or uneven terrain it is recommended that two people manoeuvre the product at all times.

Take extra care handling light heads when packing the Quad Pod away for transport in case housings are still hot.

QUAD POD WHEEL KIT

The Quad Pod is fitted with an adjustable wheel kit to increase the product's flexibility for transport and storage. The wheel kit can be adjusted via the front transport pin, or removed completely by removal of both transport pins.

LOWERING THE WHEEL KIT FOR STORAGE

The wheel kit on the Quad Pod can be lowered for storage or transportation by vehicle.



Wheel storage position

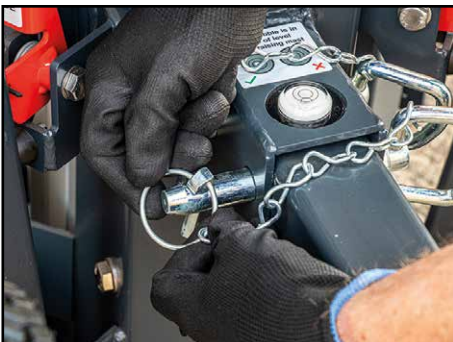

To lower the wheel kit into the storage position remove the spring locking pin, Take the weight of the wheels and pull out the transport pin closest to the wheels. Gently lower the wheels and replace transport pin to secure in the lowered position.

REMOVING THE WHEEL KIT

The Quad Pod wheel kit can be removed completely for more compact storage or during transportation by vehicle.



To remove the wheels completely take the weight of the wheels, remove the spring locking pins and then remove both pins taking care not to drop the wheels. Enlist the help of others if necessary.

TRANSPORTING THE QUAD POD VIA FORKLIFT

When transporting the Quad Pod around a site with a forklift ensure that the wheel kit is set up as it would be for use to prevent any damage to the wheels from the forklift's forks. Transport with the Quad Pod wheels towards the forklift. Ensure the forks are fully inserted into the forklift pockets before lifting.

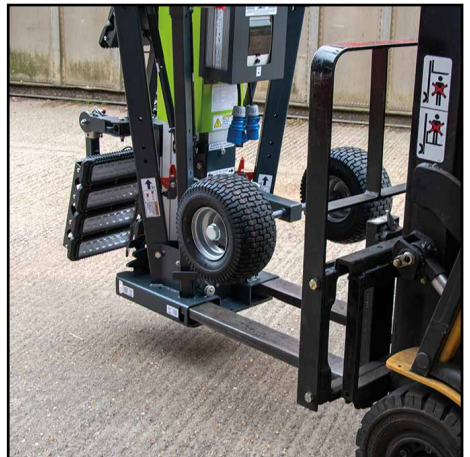

WARNING

When the wheel system is folded down or removed, do not attempt to tip the Quad Pod back to try and move it, the weight of the entire system will be realised and not supported/controlled by the counter balance wheel system. This could lead to serious injury.



Before moving the unit ensure the wheels are in transport position. The wheels must be horizontal and both pins must be fully and correctly located in the top holes of the bracket. The spring locking pins must also be in place before allowing the weight of the unit to be placed on the wheels.

TRANSPORT AND LIFTING INSTRUCTIONS

- The transport vehicle must be parked on a level surface.
- The transport vehicle must be secured to prevent rolling while the Quad Pod is being loaded.
- Be sure the vehicle capacity, loading surfaces and chains or straps are sufficient to withstand the Quad Pod's weight. See the serial plate on the Quad Pod for exact weight.
- The Quad Pod must be secured to the transport vehicles with chains or straps of ample load capacity.

LOADING THE QUAD POD

Ensure that the Quad Pod wheel kit is in transport position as identified above.

Manoeuvre the Quad Pod into position next to the vehicle either by pushing it on its wheels or using the forklift lifting points.

Use correct lifting techniques to load the Quad Pod into the transport vehicle using the fork lift lifting points within the base.

Secure the Quad Pod on the transport vehicle using the tie down points.

When loading or unloading a Quad Pod two people are recommended to prevent injury during the loading or unloading process.

Section 7: MAINTENANCE

- It is recommended that all Quad Pod products are PAT tested at least on an annual basis. Owner / manager to assess and decide frequency of PAT testing required depending on regularity or type of use.
- It is recommended that a regular inspection of the complete product is carried out to look for signs of wear and tear and identify possible maintenance required. This should be done by a competent person on at least an annual basis depending on severity and types of use.
- It is recommended that gloves are worn during cleaning and maintenance to protect the user.
- It is recommended that the light heads (load) are removed during deep maintenance.
- When removing the light heads (load) during deep maintenance or the removal of parts, ensure the product is laid flat to prevent uncontrolled movement of the mast sections in disassembly.
- Any damaged parts that could pose a risk to the user/personnel must be replaced.
- All sliding and rotating mechanisms must be kept clean and lubricated where applicable.
- Never lubricate the winch brake.
- The Quad Pod must be taken out of service if, during use, or repair and maintenance serious damage is discovered.
- The Quad Pod can only be put back into use after it has been properly repaired and examined and signed off by authorised personnel.
- The use of spares other than original parts from Ritelite (Systems) Ltd will invalidate any warranty.



The contents of this manual are subject to change without prior notice. We take no responsibility for errors or admissions.

Ritelite (Systems) Ltd

Meadow Park, Bourne Road, Essendine, Stamford, Lincolnshire, PE9 4LT, UK

Tel. +44 (0) 1780 758585 | E-mail. sales@ritelite.co.uk

www.riteliteportablelighting.co.uk