



# K-LiTE LITHIUM (L2) BATTERY REPLACEMENT GUIDE



**PRODUCT CODE:**  
**SLK10SB/L2PLUS**

This guide explains how to replace the Lithium (L2) battery in the Ritelite K9 or K10 portable work lights. The battery can be replaced in approximately 5 to 10 minutes per unit.



## WARNING

- The battery replacement should only be carried out by a competent technician.
- Only Ritelite K-LiTE batteries should be used. Any other batteries will invalidate the warranty.
- Ensure the battery is swapped for the same type. Other battery types are not compatible with this unit.
- The old battery must be disposed of correctly. Check local regulations.
- If you have any queries with the replacement of the battery please contact Ritelite for advice. We also offer a repair service so can replace batteries in units or repair any other fault if they are returned to us.

# TOOLS REQUIRED

- 4mm allen key or hex end for an electric screwdriver / battery drill

# BATTERY REPLACEMENT INSTRUCTIONS

**YOUR LITHIUM (L2) K9 OR K10 COULD HAVE ONE OF TWO TYPES OF BATTERY INSTALLED. OPEN THE UNIT AS BELOW AND CHECK YOU HAVE THE LARGER TYPE BATTERY. IF THE UNIT HAS THE SMALLER BATTERY THE UNIT MUST BE RETURNED TO RITELITE (SYSTEMS) LTD FOR BATTERY REPLACEMENT.**



1. Remove the light head from the base unit, and turn the unit upside down. Remove the 4 poles from the base. Unscrew the 4 x 4mm hex bolts (2 are located under the pole retainer). DO NOT remove the pole retainer.

2. Lift the grey section from the blue section of the base. If possible keep the bolts and washers in place as this will ease reassembly later. There is a cable attached to the base for the in-built charger, there is no need to disconnect this. Check your unit has the larger battery, as shown below on the right. If it has the smaller battery shown on the left the unit must be returned to Ritelite for battery replacement.

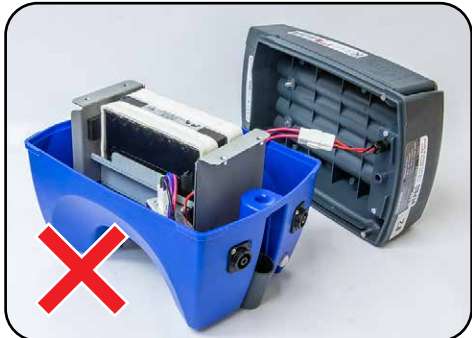

**SMALL BATTERY - RETURN TO RITELITE FOR BATTERY REPLACEMENT**

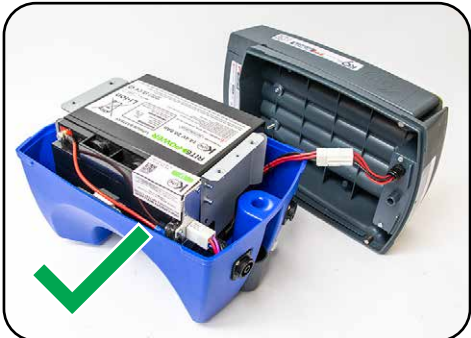

**LARGE BATTERY - OKAY TO PROCEED TO STEP 3 WITH REPLACEMENT**



3. Carefully lift the battery from the blue base, stand it upright on your work bench next to the blue base. The cable is long enough to allow this.

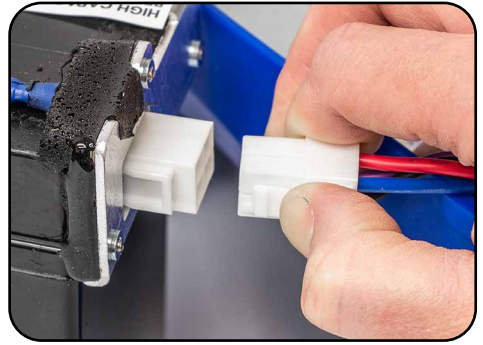

4. You can now get to the battery connector. There is a tab on the side of this, press this in and disconnect the cable.



5. Check the new battery has a green lozenge on the label and similar connector to the one it was replacing.

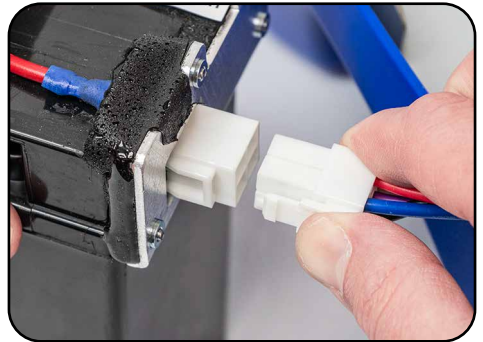

6. Reconnect the battery to the cable connector. The tab should be on the left as shown. Push in until it clicks into place.

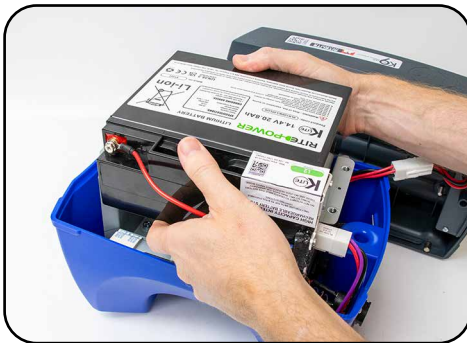

7. Place the replacement battery into the bracket, the same way around as it came out. Take care not to trap your fingers between the battery and bracket.



8. Tuck the cable down the side of the battery bracket, ensure the cable is not twisted or caught by the bracket. Sit the grey base loosely on top.



**9.** Carefully fit the grey section of the base fully back onto the blue part of the base checking no cables are obstructing.



**12.** Tighten the four hex bolts. If any have fallen out, washers will need to be put back in by passing under the pole retainer. The bolts will fit through the holes in the retainer.



**13.** Once the base is secure turn the unit over back onto its base. Slide all poles back into the pole retainer. Reattach the light head.



**14.** Test the unit is working correctly by powering on the light head. If working as it should the battery replacement is complete.

## ADVICE ON DISPOSAL OF RITELITE PRODUCTS AT END OF LIFE

For our latest advice on the disposal of Ritelite products at end of life please visit the link below.

**<https://www.ritelite.co.uk/disposal-advice>**

The contents of this manual are subject to change without prior notice.

We take no responsibility for errors or admissions.

### **Ritelite (Systems) Ltd**

Meadow Park, Bourne Road, Essendine, Stamford, Lincolnshire, PE9 4LT

Tel. +44 (0) 1780 758585 E-mail. [sales@ritelite.co.uk](mailto:sales@ritelite.co.uk)

**[www.ritelite.co.uk/batteries-and-chargers/](http://www.ritelite.co.uk/batteries-and-chargers/)**